

Instructions

Bellevue AJ10 Arne Jacobsen 1929



Congratulations on your new Bellevue lamp designed in 1929 by Arne Jacobsen. We hope you will enjoy using this product and follow these instructions to ensure correct installation. If you have any questions or comments, please do not hesitate to contact us by mail at: info@andtradition.com

&Tradition®

Bellevue AJ10

Arne Jacobsen

1929

Please read these instructions carefully and retain them for future reference to ensure that the product is used correctly. For your own safety, please study each step of this instruction manual first. &Tradition is not responsible for any faults or damages caused by not following these instructions correctly. Do not modify this product in any way.

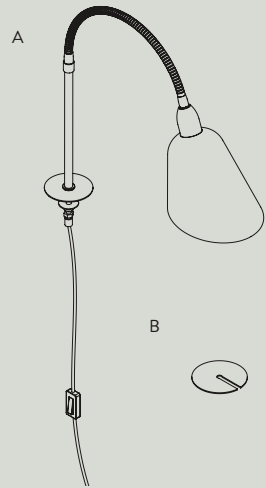

Contents

- A Lamp
- B Bottom plate for fixation

Tools needed

- Bulb type E14
- Electric drill
- Wrench

Safety precautions

- Dispose of plastic bag from packaging and do not allow children to play with it.
- Keep product well out of children's reach.
- The lamp is only intended for interior use.
- Consult a professionally qualified electrician if in any doubt.
- Do not place the cable within reach of small children or anywhere there is a risk of falling over it.
- If the external cable or cord of this lamp is damaged, it must be replaced by the manufacture or a similar qualified person in order to avoid a hazard.

Cleaning instructions

- Wipe surface of lamp shade with a soft, damp sponge or cloth, and wipe immediately after with a dry cloth.
- Do not use any abrasive cleaning tools such as steel wool, scouring sponges or stiff brushes.
- Never use strong cleaning agents such as white spirit, terpentine household glass cleaner or cellulose thinners.
- Only wipe the inside of the shade with a soft, damp cloth or feather duster.

For indoor use only
E14 maximum 25W
Bulb not included

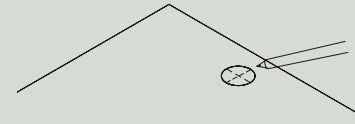

Step 1

Identify the desired location for the lamp on the table top and mark the middle using a pencil. Next, drill a hole using a hole drill. The hole should be 50mm in diameter for a CE plug, and 20mm without CE plug.

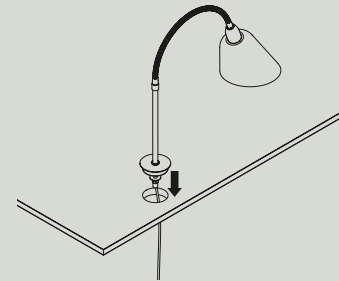

Step 2

Place the lamp (A) in the drilled hole. Be sure to place the cord in first.

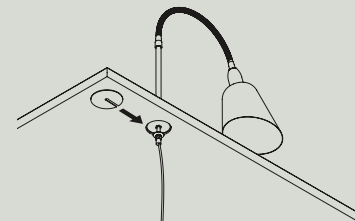

Step 3

Slide the bottom plate (B) around the bolt, beneath the table top but above the washers.



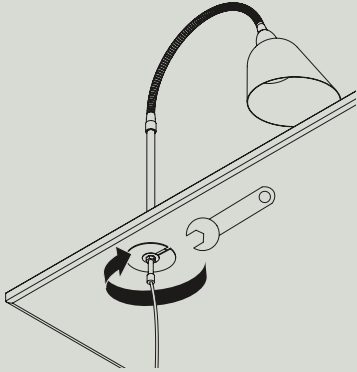

Step 4

Tighten the nut by turning it in a counter-clockwise direction, using a wrench.

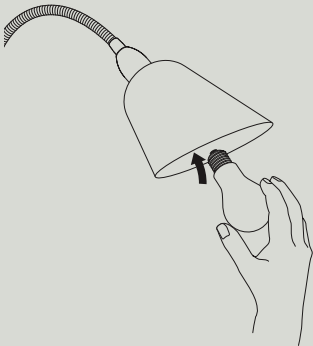

Step 5

Install the light bulb.

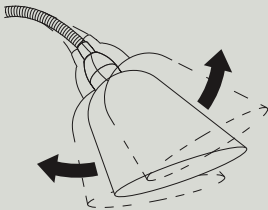

Step 6

Use the flexible swan-neck to set the shade at a desired angle. It is best to set the angle before turning on the lamp as the shade gets hot when the lamp is in use for longer periods at a time.